

**NOW DETECTS  
BUPRENORPHINE!**



## CLIAwaived,™ Inc. RAPID DIP DRUG TEST

Capable of testing up to 12 drugs (or nine drugs and four adulterants) this dip card allows for an easy mix and match of tests. The device features a flat design and clear cap that can be photographed without fear of contamination.

- CLIA-waived for 12 drugs
- Rapid results, ready in five minutes
- Room temperature storage for 18 months



RAPID DIP DRUG TEST **													PACKAGING: 25 TESTS	
Tests for:	THC 50	COC 300	OPI 300	AMP 1000	MET 500	PCP 25	BZO 300*	BAR 300*	MTD 300	OXY 100*	MDMA 500	BUP 10	ADULTERANTS (CR • NI • PH • OX)	Catalog #
5 Panel	■	■	■		■		■							CLIA-RDDT-13
	■	■	■	■	■									CLIA-RDDT-19
8 Panel	■	■	■	■	■		■	■		■				CLIA-RDDT-44
9 Panel	■	■	■	■	■		■	■	■	■				CLIA-RDDT-52
	■	■	■	■	■		■	■	■	■			■	CLIA-RDDT-52A
11 Panel	■	■	■	■	■	■	■	■	■	■	■			CLIA-RDDT-70
12 Panel	■	■	■	■	■	■	■	■	■	■	■	■		CLIA-RDDT-88

**Reimbursement Information: CPT Code # G0434QW, 80104 – Drug screen, other than chromatographic; any number of drug classes, by CLIA-waived test or moderate complexity test, per patient encounter. National Limit Amount – \$20.47**

\*There are no uniformly recognized cutoff levels for drugs of abuse testing for Benzodiazepine, Oxycodone, Tricyclic Antidepressant and Barbiturates. The test is not intended to screen or monitor individuals who are prescribed these drugs by a physician; the test may yield positive results for individuals taking such drugs, as prescribed.

\*\*NOTE: The CLIAwaived,™ Inc. Rapid Dip Drug Test (RDDT) provides only preliminary test results for drugs-of-abuse. For a quantitative result or to confirm positive results obtained by the CLIAwaived,™ Inc. Rapid Dip Drug Test, a more specific alternative chemical method must be used. Gas Chromatography/Mass Spectrometry (GC/MS) is the preferred confirmatory method.

DISCLAIMER – The CPT information contained in this document is provided as representative examples of reimbursement in this category. It is intended to assist providers in accurately obtaining reimbursement for healthcare services. It is not intended to increase or maximize reimbursement by any payor. Providers should consult their payor organizations with regard to local reimbursement policies. The information provided in this document is for information purposes only and represents no statement, promise or guarantee by CLIAwaived,™ Inc. All CPT codes are supplied for information purposes only and represent no statement, promise or guarantee by CLIAwaived,™ Inc. that these codes will be appropriate or that reimbursement will be made. CPT codes and descriptions are copyrights of the American Medical Associations. CPT does not include fee schedules, relative values or related ratings. The source for this information is the Center for Medicare and Medicaid Services. The content provided by the Center for Medicare and Medicaid Services is updated frequently. It is the responsibility of the service provider to confirm the appropriate coding required by their local Medicare carriers, fiscal intermediaries and commercial payors. All product information and prices are subject to change without notice at any time. Please call our office before ordering to verify current prices.

# RAPID DIP DRUG TEST

The **CLIAwaived,™ Inc. Rapid Dip Drug Test** is a one-step dip card test for the rapid qualitative detection of drugs of abuse in human urine.



1

Remove the test from the pouch by tearing at the notch.



2

Detach the bottom cover by pulling gently.

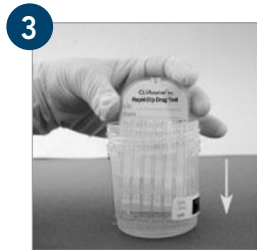

3



Dip the test straight into the urine for a minimum of 10 seconds. **DO NOT** dip beyond the tip of the arrows.



4

Remove the test from the urine. Re-attach the bottom cover and lay the device on a flat surface. Look at each test strip and interpret results at 5 minutes.

⚠ Please refer to package inserts for detailed instructions and technical information.

-  FDA-cleared
-  CLIA-waived
-  CE-marked

**CLIAwaived™ Inc.**

For more info, please call: **888.882.7739**

Visit us online at: **www.cliawaived.com**