

# The easiest way to test for lead

*Test, educate and take action, all in one visit.*



*“ We switched to LeadCare® II and love it! We get results right away and don't have to contact patients for follow-up. ”*

*- Dr. Ben Spitalnick, Pediatrician*

- **Convenient**  
CLIA-waived, just two drops of blood.
- **Patient satisfaction**  
Parents appreciate a single visit and a simple fingerstick.
- **Immediate action**  
Results in 3 minutes, while the patient waits.
- **Saves time**  
Eliminates the need for post-visit follow up.
- **Boosts compliance**  
Ensures the test gets done.
- **Reimbursable**  
CPT code 83655

# What your peers love about leadcare® II

Ease of Use | Workflow Efficiency | Accuracy

## TESTING IS AS EASY AS 1, 2, 3

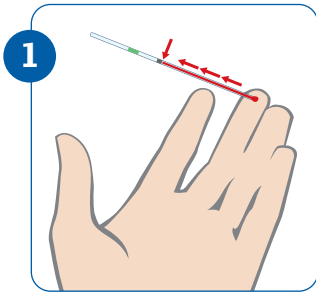

**1**  
**Collect:** 50 µL capillary whole blood (tubes included in the test kit).

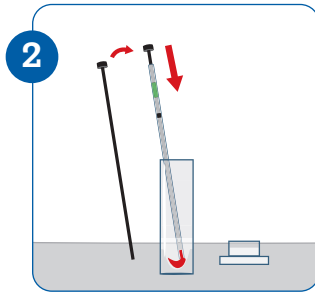

**2**  
**Prepare:** Dispense blood into a treatment reagent tube and mix.

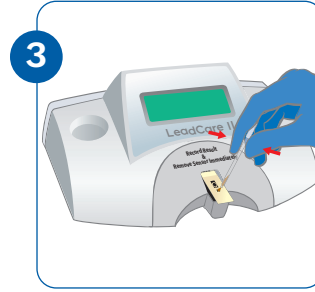

**3**  
**Test:** Place a drop of sample on the sensor; results in 3 minutes.

**“ Increased screening significantly. Paid for itself in 9 months. ”**

- Laura Rae Morette, CPNP

**“ We love the test - quick, easy, accurate! ”**

- Debra Mykkanen, FNP

## ACCURATE

Compares to GFAAS Reference Method\*

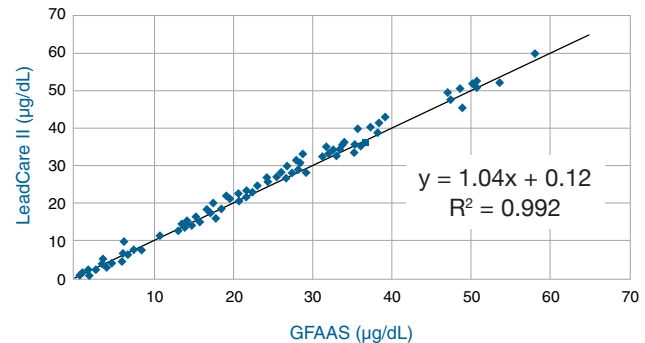

## WE MAKE STARTUP SIMPLE

- Online video training & certification.
- Technical phone support for troubleshooting.
- Free patient educational materials.
- All you need is an analyzer & a test kit (includes materials & controls for 48 tests).

**“ Easy set up, easy testing & fast results. ”**

- Elide S. Silva, RN, BSN

888-763-6769 | [LeadCare2.com](http://LeadCare2.com)  
[info@meridianbioscience.com](mailto:info@meridianbioscience.com)

LeadCare® II Analyzer Catalog Number: 70-6760

LeadCare® II Blood Lead Test Kit Catalog Number: 70-6762

\*LeadCare® II Blood Lead Test Kit Package Insert

© 2024 All rights reserved. LeadCare is a registered trademark of Meridian Bioscience. M-0105 Rev 03

**meridian** BIOSCIENCE®  
LIFE DISCOVERED. LIFE DIAGNOSED.