



Clearly different.  
**Clearly better.**



Women's Health | Infectious Disease | Cardiovascular | Drugs of Abuse | GI Disorders

## Clearview® Mono

### **Clearview Mono**

Two-step technology provides a quick, easy solution for diagnosing Infectious Mononucleosis.



### **Clearly different**

*Clearview's patented innovative technology provides highly sensitive and specific tests for Infectious Mononucleosis (IM).*

- **Rapid Response:** Two-step test, with results in 5 minutes.
- **Simplicity:** CLIA waived\*, easy-to-use test requires no training.
- **Reliability:** Built-in control ensures accuracy.
- **Flexibility:** Use with multiple sample types — whole blood, serum or plasma.

### **Clearly better**

**Clearview Mono provides a clear solution to the common challenge of diagnosing Infectious Mononucleosis (IM).**

- Immediate therapy reduces time of discomfort for patient.
- Minimizes the risk of more serious illness.
- Reduces the spread of virus to others.

**CLIAwaived.com™**

For more information please contact CLIAwaived Inc. at  
11578 Sorrento Valley Road ■ San Diego, CA 92121  
Tel: (858) 481-5031 ■ Toll Free: (888) 882-7739  
E-mail: [info@cliawaived.com](mailto:info@cliawaived.com)  
Visit us on the web at: [www.cliawaived.com](http://www.cliawaived.com)  
Distributed by: CLIAwaived, Inc.

\* for whole blood specimens

*Point of Care Diagnostics*

 **inverness medical**  
*professional diagnostics*



**Clearview Mono**  
30 Test Kit  
Order No. 92401

*Whole Blood - CLIA Waived*  
*Serum, Plasma -*  
*Non-waived*

**Clearview Mono Comparison Grid**

Product Name	Clearview Mono	Quidel QuickVue® + Infectious Mono	Genzyme OSOM® Mono
<i>Format</i>	30 Cassettes	20 Cassettes	25 Dipsticks
<i>CLIA Status</i>	Waived: Whole Blood Non-waived: Whole Blood, Serum or Plasma	Waived: Whole Blood Non-waived: Whole Blood, Serum or Plasma	Waived: Whole Blood Non-waived: Whole Blood, Serum or Plasma
<i>Sample</i>	Whole Blood (Fingerstick or Venipuncture), Serum or Plasma	Whole Blood (Fingerstick or Venipuncture), Serum or Plasma	Whole Blood (Fingerstick or Venipuncture), Serum or Plasma
<i>Sensitivity</i>	98% *	99.9%	100%
<i>Specificity</i>	>99% **	99.8%	90.3%
<i>Procedural Steps</i>	2	2	3
<i>Time to Result</i>	5 minutes	5 minutes	5 minutes
<i>Shelf Life</i>	18 months	18 months	12 months
<i>Storage</i>	Room Temperature	Room Temperature	Room Temperature

**Clearview Mono Procedure**

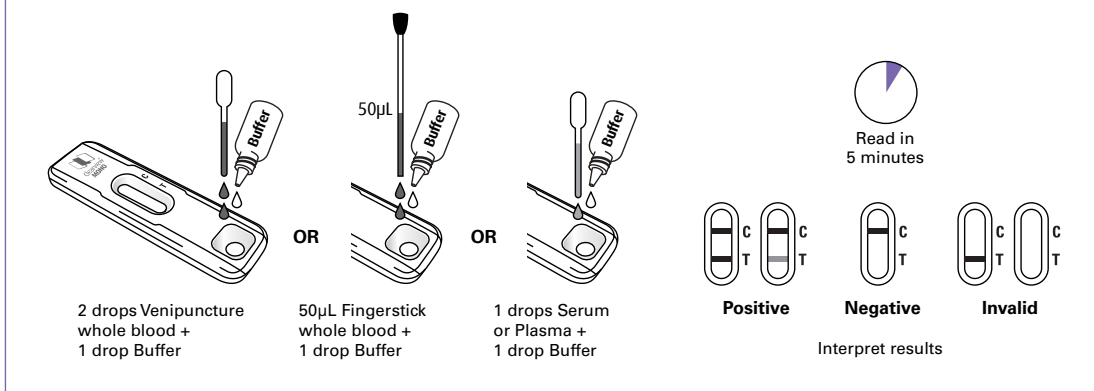

\* positive agreement with comparative test  
\*\* negative agreement with comparative test

All trademarks referenced are trademarks of their respective owners. All rights reserved.

331 S. 104th Street  
Louisville, CO 80027 USA  
www.invernessmedicalpd.com

1.800.637.3717  
P: 303.530.3888  
F: 800.637.3827

© 2006 Inverness Medical–BioStar Inc.  
02902.00

visit  
[www.invernessmedicalpd.com](http://www.invernessmedicalpd.com)  
for more information

